

### Specifications

Nominal Voltage		12 V
Capacity(10HR, 25°C)		9Ah
Dimension	Length	151 ± 2mm (5.94inch)
	Width	87 ± 2mm (3.43inch)
	Height	107 ± 2mm (4.21inch)
Approx. Weight		3kg (6.61lbs) ± 5%
Operating temperature range		-20°C ~ 50°C (-4°F ~ 122°F)
Standard Charging method (25°C)	Current	0.9A
	Time	5~10h
Quickly Charging method (25°C)	Current	4.5A
	Time	1h
Terminal material		Lead
Container Material		ABS

### Dimensions

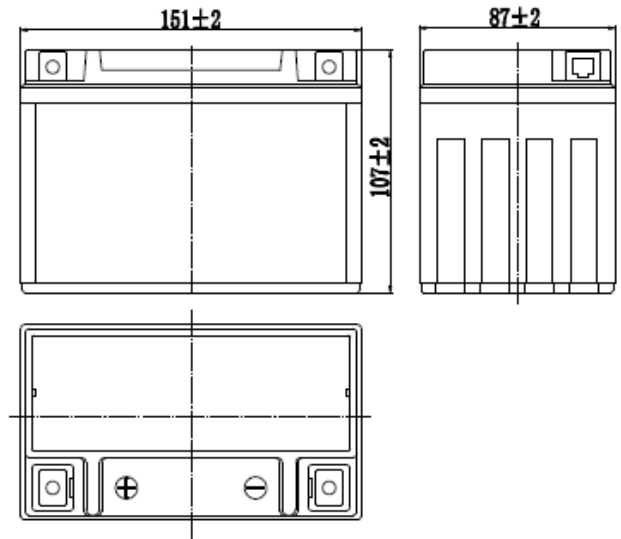

### Terminal

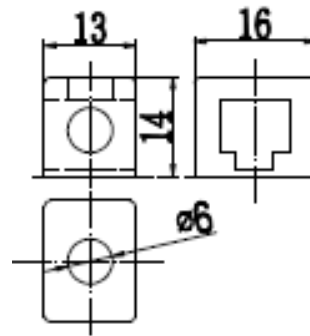

### Discharge Characteristics(25°C)

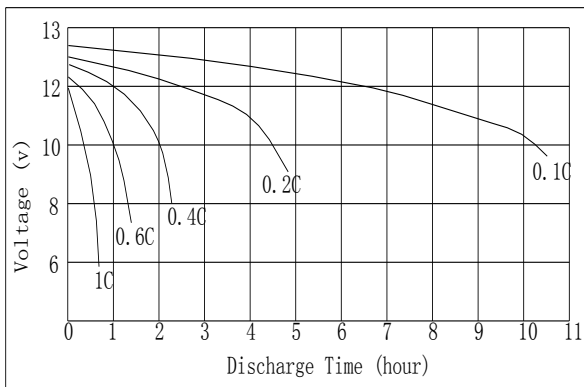

### Self-discharge characteristics

