

Specifications

Nominal Voltage		12 V
Capacity(10HR, 25°C)		12Ah
Dimension	Length	152±2mm (5.98inch)
	Width	88±2mm (3.46inch)
	Height	130±2mm (5.12inch)
Approx. Weight		3.7kg (8.16lbs)±5%
Operating temperature range		-20°C ~ 50°C (-4°F ~ 122°F)
Standard Charging method (25°C)	Current	1.2A
	Time	5~10h
Quickly Charging method (25°C)	Current	6A
	Time	1h
Terminal material		Lead
Container Material		ABS

Dimensions

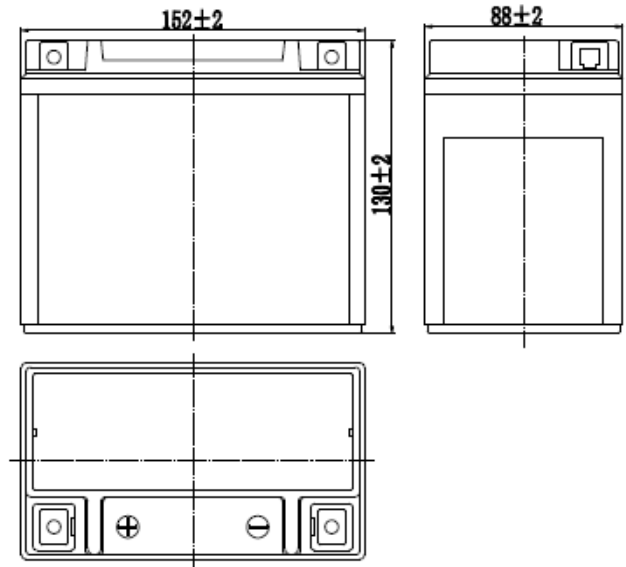

Terminal

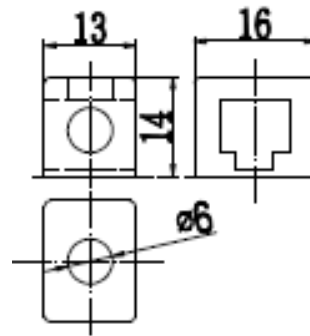

Discharge Characteristics(25°C)

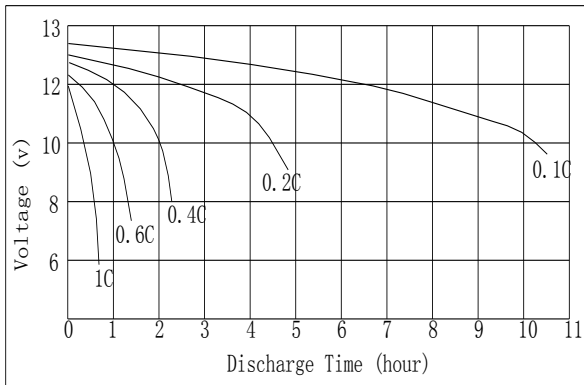

Self-discharge characteristics

