

**Specifications**

Nominal Voltage		2 V
Capacity (25°C)	10HR(1.80V)	500 Ah
	3HR(1.75V)	390Ah
	1HR(1.75V)	290Ah
Dimension	Length	241 ± 2mm (9.49inch)
	Width	175 ± 2mm (6.89inch)
	Height	330 ± 2mm (12.99inch)
	Total Height	365 ± 2mm (14.37inch)
Approx. Weight		30kg (66.1lbs) ± 4%
Terminal type		F12
Internal resistance (Fully charged, 25°C)		Approx. 0.5m Ω
Capacity affected by temperature (10HR)	40°C	102%
	25°C	100%
	0°C	85%
	-15°C	65%
Self-discharge (25°C)	3 month	Remaining Capacity: 91%
	6 month	Remaining Capacity: 82%
	12 month	Remaining Capacity: 65%
Nominal operating temperature		25°C ± 3°C (77°F ± 5°F)
Operating temperature range	Discharge	-15°C ~ 50°C (5°F ~ 122°F)
	Charge	-10°C ~ 50°C (14°F ~ 122°F)
	Storage	-20°C ~ 50°C (-4°F ~ 122°F)
Float charging voltage(25°C)		2.25 to 2.30V Temperature compensation: -3mV/°C
Cyclic charging voltage(25°C)		2.42 to 2.50V Temperature compensation: -5mV/°C
Maximum charging current		100A
Maximum discharge current		3500A(5 sec.)
Designed floating life(20°C)		15~18 years

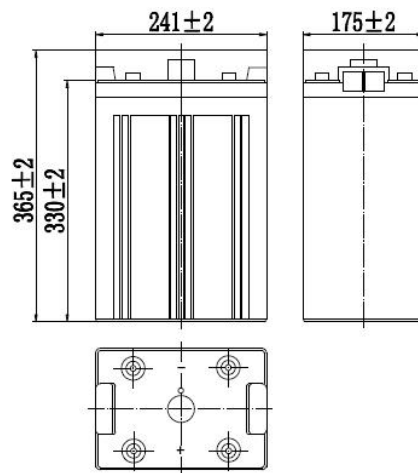

**Dimensions**



**Terminal**

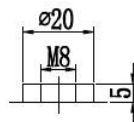

Terminal F12

**Constant Current Discharge Characteristics (A, 25°C)**

F.V/TIME	15min	30min	60min	2h	3h	4h	5h	6h	8h	10h	20h
1.60V	695	455	313	184	133	106	91.3	78.5	62.0	51.2	27.0
1.65V	678	446	308	183	132	105	90.8	78.1	61.6	51.1	26.9
1.70V	653	432	300	182	131	105	90.1	77.5	61.2	50.9	26.8
1.75V	631	422	294	179	130	104	89.5	77.0	60.8	50.6	26.7
1.80V	598	406	285	174	126	101	86.8	74.7	58.9	50.3	26.5

**Constant Power Discharge Characteristics (Watt, 25°C)**

F.V/TIME	15min	30min	60min	2h	3h	4h	5h	6h	8h	10h	20h
1.60V	1272	851	594	356	260	208	180	155	123	102	54.0
1.65V	1241	834	585	353	258	207	179	154	123	102	53.8
1.70V	1196	808	570	350	257	205	178	153	122	101	53.7
1.75V	1155	789	559	345	255	204	176	152	121	101	53.4
1.80V	1094	760	542	336	247	198	171	147	117	100	53.0

Note: The above characteristics data can be obtained within three charge/discharge cycles.

**Construction**

Component	Positive plate	Negative plate	Container	Cover	Separator	Electrolyte	Safety valve	Terminal
Raw material	Lead dioxide	Lead	ABS	ABS	AGM	Sulfuric acid	Rubber	Copper

**Discharge Characteristics(25°C)**

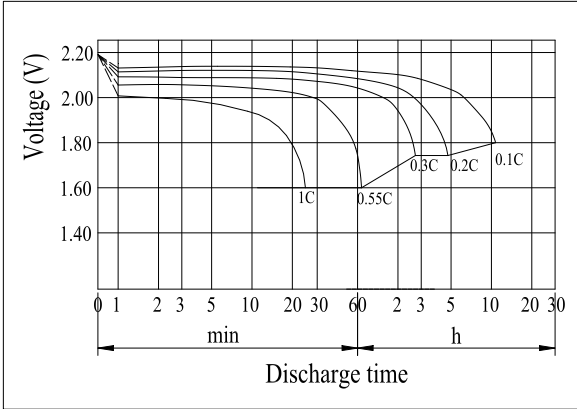

**The Relationship for Open Circuit Voltage and Residual Capacity (25°C)**

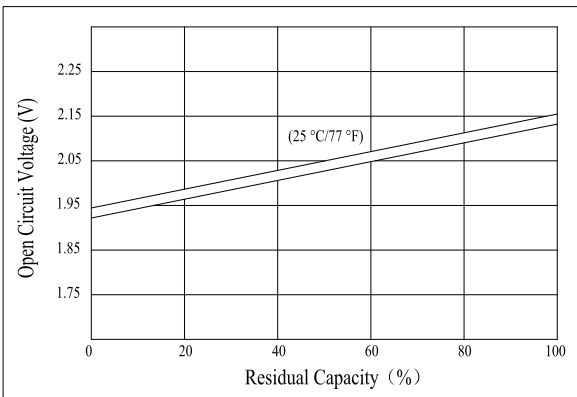

**Floating Life on Temperature**

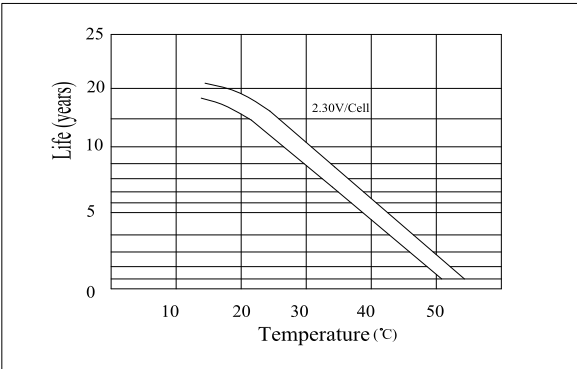

**Effect of Temperature on Capacity**

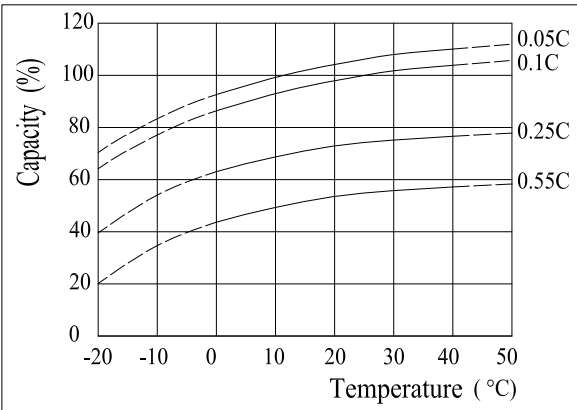

**Charging Characteristics(25°C)**

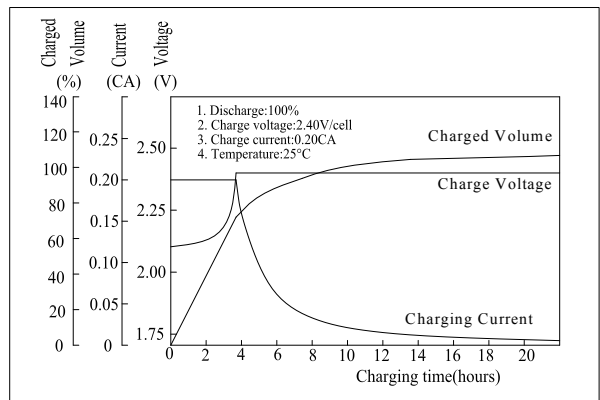

**The Relationship for Charging Voltage and Temperature**

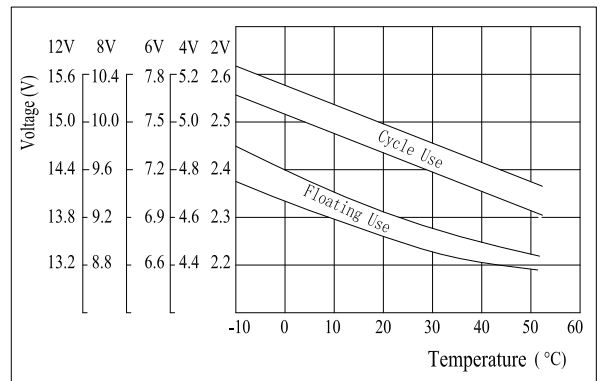

**Cycle Life on D.O.D(25°C)**

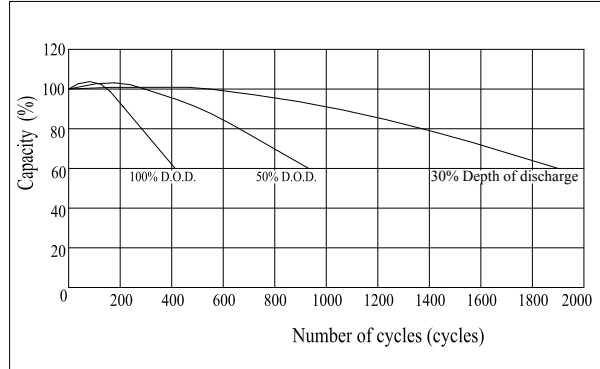

**Self-discharge Characteristics**

