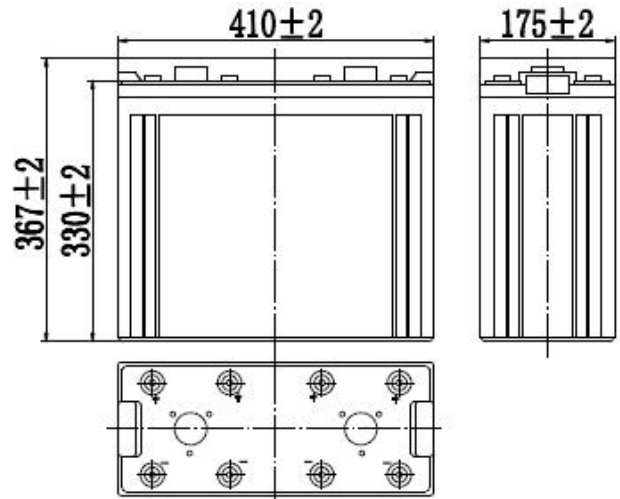
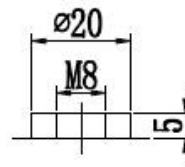

**Specifications**

Nominal Voltage		2 V
Capacity (25°C)	10HR(1.80V)	800 Ah
	3HR(1.75V)	624Ah
	1HR(1.75V)	464Ah
Dimension	Length	410±2mm (16.14inch)
	Width	175±2mm (6.89inch)
	Height	330±2mm (12.99inch)
	Total Height	367±2mm (14.45inch)
Approx. Weight		50kg (110.2lbs)±4%
Terminal type		F12
Internal resistance (Fully charged, 25°C)		Approx. 0.4mΩ
Capacity affected by temperature (10HR)	40°C	102%
	25°C	100%
	0°C	85%
	-15°C	65%
Self-discharge (25°C)	3 month	Remaining Capacity: 91%
	6 month	Remaining Capacity: 82%
	12 month	Remaining Capacity: 65%
Nominal operating temperature		25°C ± 3°C (77°F ± 5°F)
Operating temperature range	Discharge	-15°C ~ 50°C (5°F ~ 122°F)
	Charge	-10°C ~ 50°C (14°F ~ 122°F)
	Storage	-20°C ~ 50°C (-4°F ~ 122°F)
Float charging voltage(25°C)		2.25 to 2.30V Temperature compensation: -3mV/°C
Cyclic charging voltage(25°C)		2.42 to 2.50V Temperature compensation: -5mV/°C
Maximum charging current		160A
Maximum discharge current		5500A(5 sec.)
Designed floating life(20°C)		15~18 years

**Dimensions**

**Terminal**

**Terminal F12**
**Constant Current Discharge Characteristics (A, 25°C)**

F.V/TIME	15min	30min	60min	2h	3h	4h	5h	6h	8h	10h	20h
1.60V	1112	728	500	295	212	170	146	126	99.1	81.8	43.2
1.65V	1085	713	493	293	211	169	145	125	98.6	81.7	43.1
1.70V	1045	692	480	290	209	168	144	124	97.9	81.4	43.0
1.75V	1010	675	471	286	208	166	143	123	97.2	81.0	42.7
1.80V	956	650	456	279	202	161	139	120	94.3	80.4	42.4

**Constant Power Discharge Characteristics (Watt, 25°C)**

F.V/TIME	15min	30min	60min	2h	3h	4h	5h	6h	8h	10h	20h
1.60V	2035	1361	950	569	416	333	288	248	197	163	86.3
1.65V	1986	1334	936	566	413	331	286	246	196	163	86.2
1.70V	1913	1293	912	560	411	328	284	244	195	162	85.9
1.75V	1848	1262	894	552	408	326	282	243	193	161	85.4
1.80V	1750	1216	866	538	395	316	274	235	188	160	84.8

Note: The above characteristics data can be obtained within three charge/discharge cycles.

**Construction**

Component	Positive plate	Negative plate	Container	Cover	Separator	Electrolyte	Safety valve	Terminal
Raw material	Lead dioxide	Lead	ABS	ABS	AGM	Sulfuric acid	Rubber	Copper

**Discharge Characteristics(25°C)**

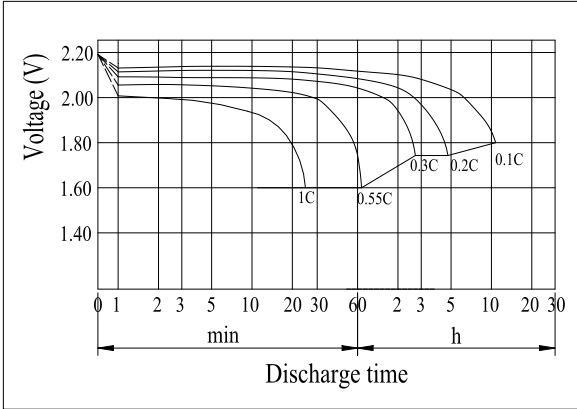

**The Relationship for Open Circuit Voltage and Residual Capacity (25°C)**

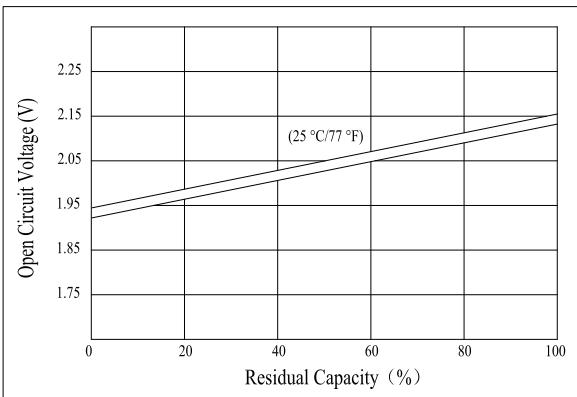

**Charging Characteristics(25°C)**

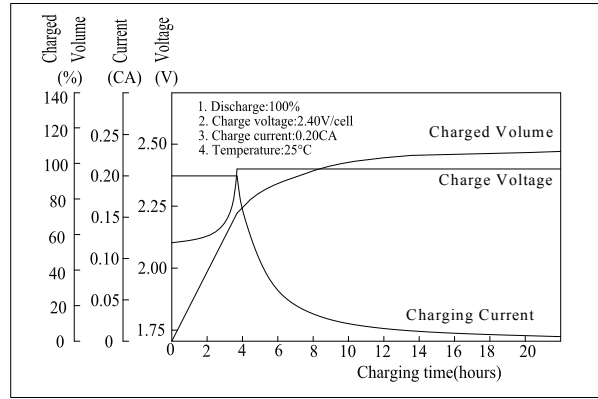

**The Relationship for Charging Voltage and Temperature**

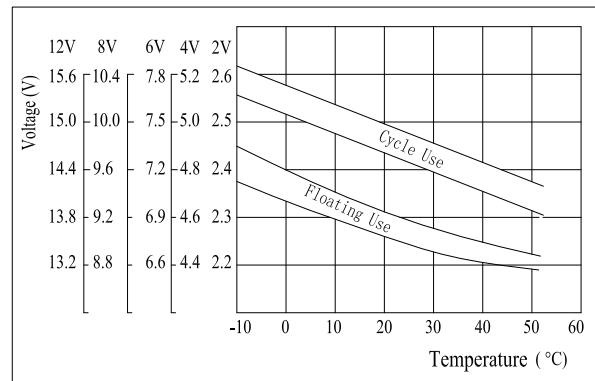

**Floating Life on Temperature**

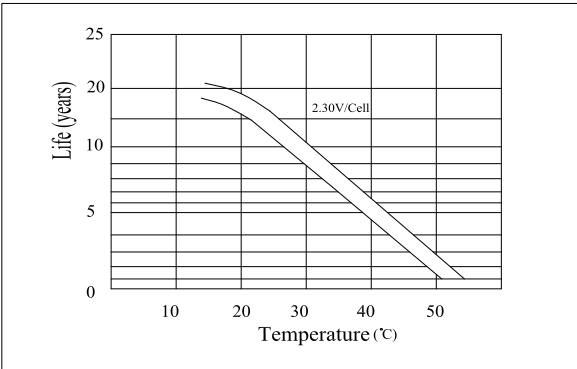

**Cycle Life on D.O.D(25°C)**

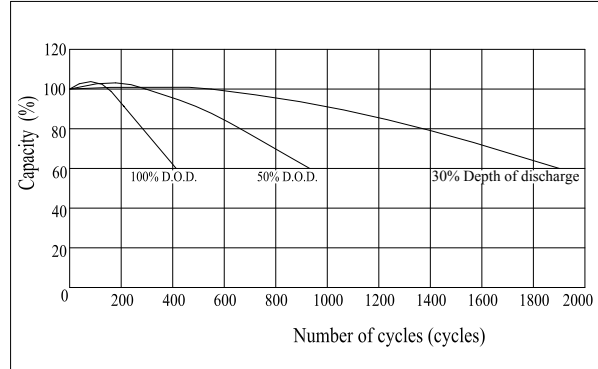

**Effect of Temperature on Capacity**

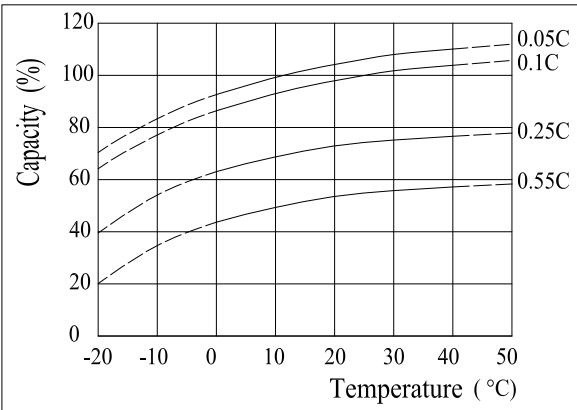

**Self-discharge Characteristics**

